

KombiSIGN 70 / Accessories

Adapter for tube D25mm 1/2 Inch thread



Part No.: 975.840.02

MECHANICAL DATA

| | |
|-----------------------|--------|
| Height | 44 mm |
| Diameter | 27 mm |
| Materials | Steel |
| Housing colour | Silver |
| Weight with packaging | 88 g |
| Product weight | 81 g |

APPROVAL DATA

| | |
|------------------------------|--------------------------------|
| Conforms with CE | No |
| Conforms with RoHS directive | Fulfills substance restriction |
| WEEE | No |
| Conforms with ATEX-directive | No |
| Conforms with CCC | No |
| Conforms with UL | No |
| Conforms with FCC | No |
| Conforms with IC | No |
| EAC certificate available | No |
| Conforms with AS-I | No |
| ICAO Certification | No |
| Conforms with DNV | No |
| Conforms with RoHS CN | No |



For additional installation and mounting information, refer to the appropriate user guide at www.werma.com. This printed copy is for information only and is subject to alteration.

KombiSIGN 70 / Accessories

Adapter for tube D25mm 1/2 Inch thread

DRAWING

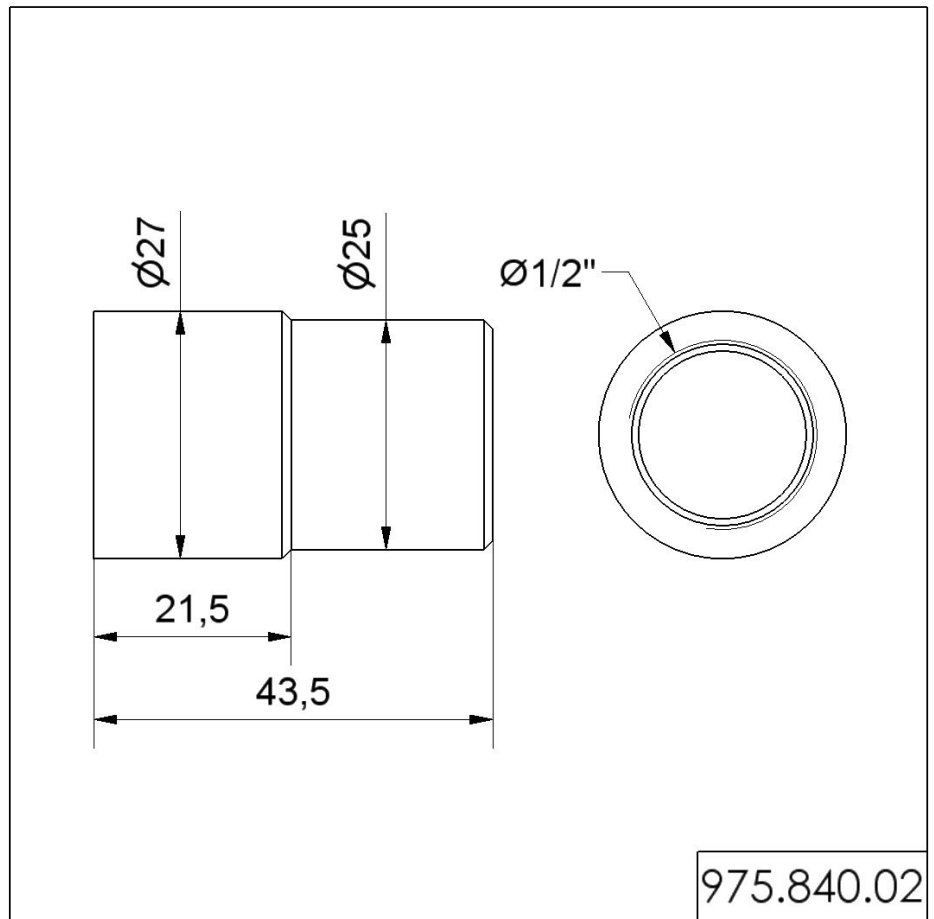

For additional installation and mounting information, refer to the appropriate user guide at www.werma.com. This printed copy is for information only and is subject to alteration.