

## Obstruction lights / LED Obstruction light 281 LED Obstruction light BM 24VDC RD



Part No.: 281.470.55



### MECHANICAL DATA

|                              |                             |
|------------------------------|-----------------------------|
| Height                       | 205 mm                      |
| Diameter                     | 165 mm                      |
| Materials                    | Aluminium<br>Glass          |
| Dome colour                  | Clear                       |
| Housing colour               | Black<br>Red                |
| Protection category          | IP66<br>IP68                |
| Connection                   | Screw terminals             |
| cross-sectional area maximum | 1,50mm <sup>2</sup> / 16AWG |
| Cable entry                  | Screwed cable gland         |
| Cable entry minimum          | d = 9 mm                    |
| Tension relief               | Present (conforms to VDE)   |
| Type of fixing               | Base mounting               |
| Working temperature minimum  | -30°C                       |
| Working temperature maximum  | +50°C                       |
| Weight with packaging        | 2160 g                      |
| Product weight               | 1920 g                      |

### ELECTRICAL DATA

|                             |                    |
|-----------------------------|--------------------|
| Operating voltage           | 24V                |
| Operating voltage type      | DC                 |
| Operating voltage tolerance | +/- 10%            |
| Rated operational voltage   | 24 VDC             |
| Rated operational current   | 500 mA             |
| Rated inrush current        | 2.000 mA           |
| Protection class            | Protection class 1 |
| Pollution degree            | 3                  |

### OPTICAL DATA

|                      |                  |
|----------------------|------------------|
| Light source         | LED              |
| Light colour         | Red              |
| Optical signal image | Permanent        |
| Intensity            | >32cd            |
| Service life optical | 50,000 h maximum |

### APPROVAL DATA

|                              |     |
|------------------------------|-----|
| Conforms with CE             | Yes |
| Conforms with RoHS directive | Yes |



For additional installation and mounting information, refer to the appropriate user guide at [www.werma.com](http://www.werma.com). This printed copy is for information only and is subject to alteration.

Obstruction lights / LED Obstruction light 281  
**LED Obstruction light BM 24VDC RD**

|                               |                               |
|-------------------------------|-------------------------------|
| WEEE                          | Yes                           |
| Conforms with ATEX-directive  | No                            |
| Conforms with CCC             | No                            |
| Conforms with UL              | No                            |
| Conforms with FCC             | No                            |
| Conforms with IC              | No                            |
| EAC certificate available     | Yes                           |
| Conforms with UKCA (Importer) | Yes (WERMA (UK) Ltd.)         |
| Conforms with CMIM            | No                            |
| Conforms with AS-I            | No                            |
| ICAO Certification            | Yes (Low Intensity Type A, B) |
| Conforms with DNV             | No                            |
| Conforms with RoHS CN         | No                            |
| Conforms with VdS             | No                            |

**DRAWING**

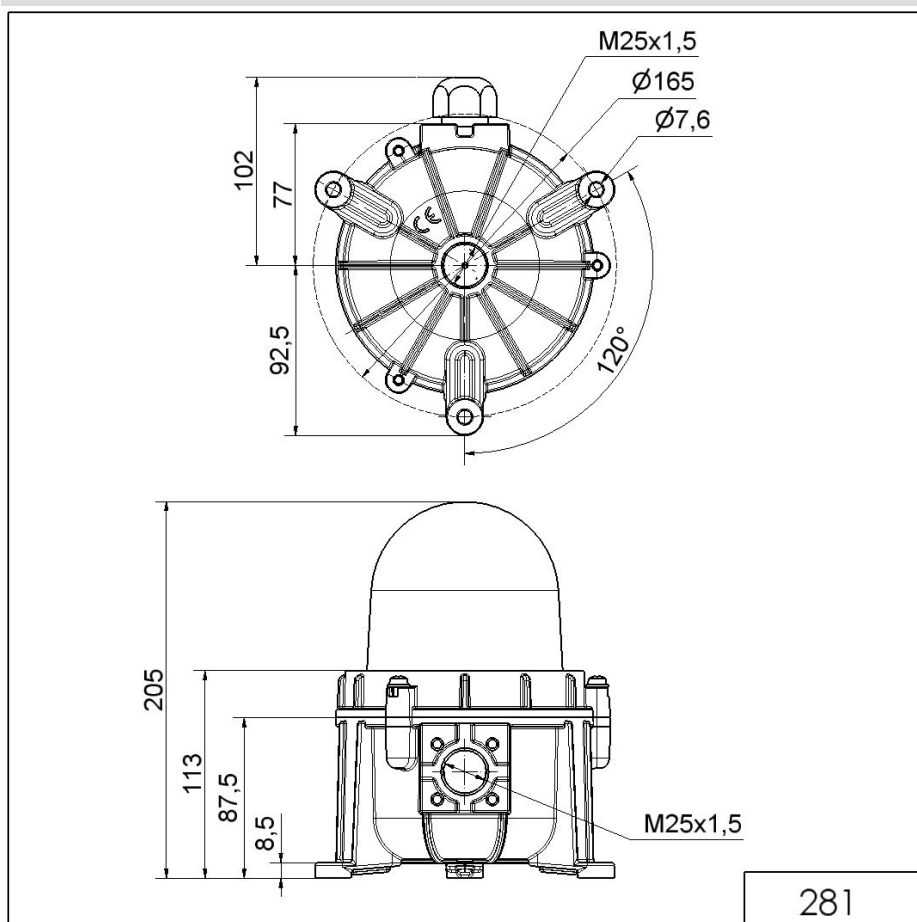

! For additional installation and mounting information, refer to the appropriate user guide at [www.werma.com](http://www.werma.com). This printed copy is for information only and is subject to alteration.